

**COUNTY OF LOS ANGELES
ROAD DEPARTMENT**

**PRECISE
BENCH MARK LIST**



LA CANADA QUAD

PASADENA QUAD

NGVD 29 DATUM

1980 ADJUSTMENT

P R E F A C E
. 1980 Adjustment

The Road Department level net published in 1975 consisted of more than 1500 miles of levels supporting in excess of 18,000 bench marks. For reasons of economy, this 1980 adjustment is reduced to about 55% of the bench marks previously published. Reductions were made by increasing the spacing between level lines in unincorporated territory, and eliminating lines in non-contract cities and areas where the probability of future engineering projects appears slight. The 1980 adjustment is an update of the remainder of the 1975 bench marks, not including baselines. Data from previous adjustments is available without inferring any responsibility for the current reliability of the data or the actual existence of the bench marks. Elevations of bench marks with the same quad name, but different adjustment dates, are not normally compatible.

To facilitate the adjustment, indexing, and distribution of adjusted values of the net, the County territory is divided into 34 quads or areas. For identification purposes each quad is given a name, viz., "Rosemead," "La Mirada," "Santa Fe," etc. When bench marks and elevations in the Road Department net are used, the name of the quad in which the bench mark is located and the date of the elevation adjustment must be included in the bench mark description, e.g.,

CY 6901 - RDEM TAG S CB 11FT E BCR @ SE COR LA CIENEGA
BLVD & LENNOX BLVD 32FT S & 73FT E C/L INT
(HAWTHORNE - 1980) ELEV. 82.549

The precision of the net is reflected by an indicated field probable error of plus or minus 0.012 foot per mile of leveling as determined from over 300 conditions of closure. However, many years experience in vertical control in the greater Los Angeles basin and Antelope Valley indicate that because of varying degrees of subsidence and heaving, the true datum is recovered only by obtaining substantial agreement between a number of bench marks.

The users of this net are invited to assist in its maintenance by notifying this Department of cases of obliteration, apparent mistakes in descriptions or elevations, and proven disturbance of bench marks.

DATUM: U. S. Coast and Geodetic Survey Sea Level Datum
of 1929, through the medium of the Los Angeles
County Engineer Precise Level Net.

ABBREVIATIONS USED IN BENCH MARK LISTINGS

ABUT - - - - -	Abutment	EC - - - - -	End of Curve
ALG - - - - -	Along	ENT - - - - -	Entrance
ANG PT - - - - -	Angle Point	FL - - - - -	Floor
B/W - - - - -	Back of Walk	FTG - - - - -	Footing
BCR - - - - -	Beginning of Curb Return	FRWY - - - - -	Freeway
BC - - - - -	Beginning of Curve	F/W - - - - -	Front of Walk
BLDG - - - - -	Building	GAR - - - - -	Garage
BM - - - - -	Bench Mark	HDWL - - - - -	Headwall
BT SPK - - - - -	Boat or Bolt Spike	HSE - - - - -	House
BR CAP - - - - -	Brass or Bronze Cap	HWY - - - - -	Highway
C B - - - - -	Catch Basin	INT - - - - -	Intersection
CTR - - - - -	Center	IP - - - - -	Iron Pipe
C/L - - - - -	Center Line	LT - - - - -	Left
C/L INT - - - - -	Center Line Intersection	LACE - - - - -	L. A. City Engineer
C/L PROD - - - - -	Center Line Produced	LACS - - - - -	L. A. Co. Engineer
CONC - - - - -	Concrete	LAFC - - - - -	L. A. Co. Flood Control
COR - - - - -	Corner	L&BN - - - - -	Lead and Bench Nail
COE - - - - -	Corps of Engineers	L&BR - - - - -	Lead and Brad
CULV - - - - -	Culvert	L&N - - - - -	Lead and Nail
CYN - - - - -	Canyon	L&SPK - - - - -	Lead and Spike
CB - - - - -	Curb	L&T - - - - -	Lead and Tack
CS MON - - - - -	Co. Engineer Monument	MCR - - - - -	Middle of Curb Return
CT SPK - - - - -	Cut Spike	MKD - - - - -	Marked
DR - - - - -	Drive or Driveway	MC - - - - -	Middle of Curve
E/O - - - - -	East of	MON - - - - -	Monument
ECR - - - - -	End of Curb Return	N/O - - - - -	North of

ABBREVIATIONS USED IN BENCH MARK LISTINGS . . . CONTINUED

NR - - - - - Near
OPP - - - - - Opposite
PI - - - - - Point of Intersection
PK&W - - - - - FK Nail and Washer
P/L - - - - - Property Line
POST - - - - - Point on Semi-Tangent
PP - - - - - Power Pole
PVMT - - - - - Pavement
PROD - - - - - Produced
RD - - - - - Road
RDBM - - - - - Road Dept. Bench Mark
RDBM TAG - - - - - Road Dept. Bench Mark Tag
RR - - - - - Railroad
RT - - - - - Right
R/W - - - - - Right of Way
SDMH - - - - - Storm Drain Manhole
SMH - - - - - Sewer Manhole
SPK - - - - - Spike
ST&W - - - - - Spike Tin and Washer
S/O - - - - - South of
TP - - - - - Telephone Pole
USC&GS - - - - - U. S. Coast and Geodetic Survey
USGS - - - - - U. S. Geological Survey
WK - - - - - Walk
W/O - - - - - West of

LA CANADA QUAD

8-21-80

CASTLE RD

LOS AMIGOS ST

JESSEN DR

ALTA CANYADA RD

FAIRMOUNT AVE

EL VAGO ST
LA CANADA BLVD

VISTA DEL VALLE RD

ANGELES CREST HWY

LYNNHAVEN LANE

WILADONDA DR

DAKWOOD AVE

FOOTHILL

MICHIGAN AVE

BLVD

CREWY CHASE DR

HIGHLAND

WOODBURY RD

WINDSOR AVE

ALTADENA DR

7685 AVE

7684
7683

5078
5077
507

6506
4533

6505
4530

4528

4684
4683

770P
7708

LINCOLN

PASADENA QUAD

BOUNDARY

CITY

BOUNDARY

PASADENA

LIGHT SOLID LINES WITHOUT NUMBERS INDICATE PREVIOUS LINES OF BENCH MARKS THAT ARE NOT INCLUDED IN THE 1980 ADJUSTMENT.

MILE



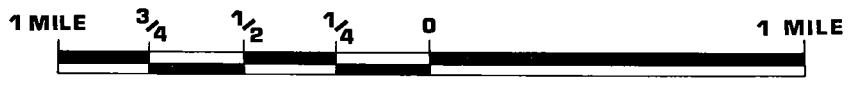
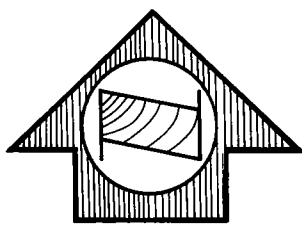
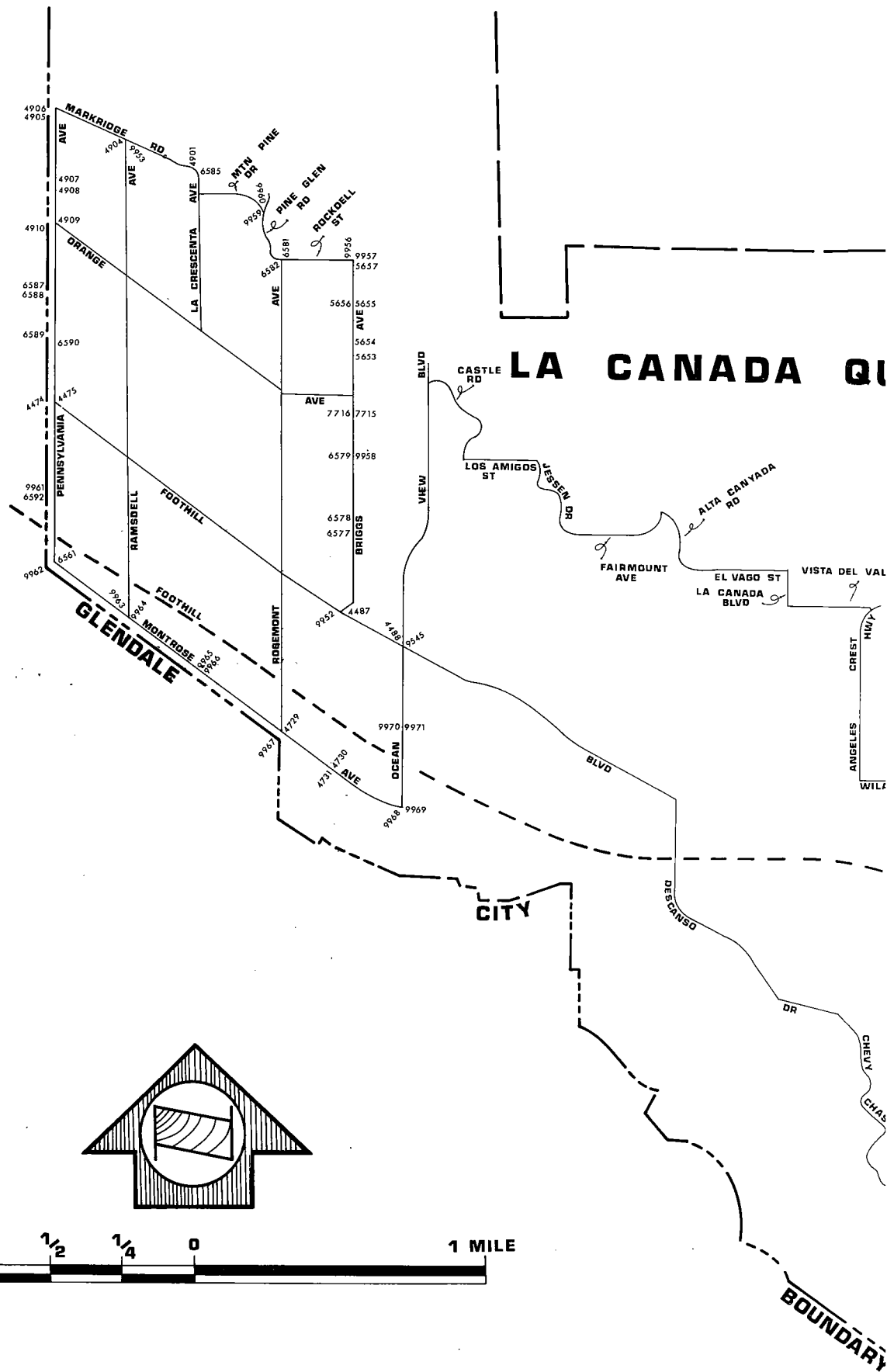

QUAD-YEAR	ELEV	DESCRIPTION (INCLUDE QUAD AND YEAR IN DESCRIPTION)	BM NUMBER
BASELINE (1975)	714.305	L&BN 29FT N/O BCR @ NE COR SIERRA MADRE VILLA AVE & FOOTHILL BLVD 98FT N & 28FT E C/L INT	CG 1247
BASELINE (1975)	720.743	RAMSET 1FT W BCR @ NW COR SANTA PAULA AVE & FOOTHILL BLVD 51FT W & 30FT N C/L INT	CG 1249
BASELINE (1975)	739.232	L&BT SPK 2FT E BCR @ SE COR DAISY AVE & FOOTHILL BLVD 42FT E & 32FT S C/L INT	CG 1251
BASELINE (1975)	738.135	LACS BM MON IN WELL 51FT S & 15FT E OF C/L INT FOOTHILL BLVD & DAISY AVE MKD (BM 10-8 1952 RE 63)	CG 1252
BASELINE (1975)	687.629	L&BN S CB FOOTHILL BLVD 0.1MI W INT ROSEMEAD BLVD 34FT S C/L IN CTR C B FRONT OF BLDG NO 3600	CG 1254
BASELINE (1975)	666.808	SMALL SPK & W N CB 1FT E/O BCR @ NE COR DEXTER AVE & FOOTHILL BLVD 49FT E & 27FT N C/L INT	CG 2494
BASELINE (1975)	670.152	L&BN E CB 1FT S/O BCR @ NE COR FOOTHILL BLVD N SERV RD & DEXTER AVE 25FT N & 21FT E C/L INT	CG 2495
BASELINE (1975)	591.350	LACS BR CAP MON IN WELL 1FT N C/L FOOTHILL BLVD & 70FT E C/L BURNELL OAKS LN MKD (SIERRA MADRE G 6 1940 RE2177)	CG 2502
BASELINE (1975)	661.239	SPK E CB 6FT S/O BCR @ SE COR CALIFORNIA BLVD & SAN GABRIEL BLVD 58FT S & 27FT E C/L INT	CG 3053
BASELINE (1975)	721.306	SPK CTR CB RET @ NW COR COLORADO BLVD & SAN GABRIEL BLVD 41FT N & 34FT W C/L INT	CG 3056
BASELINE (1975)	727.818	L&BN 5FT E/O BCR @ SE COR DAISY AVE & WALNUT AVE 35FT E & 30FT S C/L INT	CG 3057
BASELINE (1975)	556.899	RAMSET 1FT S BCR @ SW COR FOOTHILL BLVD & RANCHO RD 61FT S & 18FT W C/L INT	CG 3060A
BASELINE (1975)	543.075	LACS BR CAP MON IN WELL C/L FOOTHILL BLVD 26FT E C/L SANTA ANITA AVE MKD (SIERRA MADRE I-6 1940 RE2177)	CG 3061
BASELINE (1975)	714.005	LACS BM MON IN WELL 1FT E/O E CB @ NE COR 117FT N & 29FT E C/L INT FOOTHILL BLVD & SIERRA MADRE VILLA AVE MKD (BM 10-9A RE5869 1962)	CG 3094
BASELINE (1975)	654.356	RDBM TAG 1FT E/O BCR @ NE COR SERV RD ENT & FOOTHILL BLVD 26FT E & 27FT N C/L INT 246FT W INT DGN ALVARADO DR	CG 3594
BASELINE (1975)	719.875	L&BN 2FT S/O BCR 49FT S & 32FT W C/L INT COLORADO BLVD & SAN GABRIEL BLVD	CG 3603

QUAD-YEAR	ELEV	DESCRIPTION (INCLUDE QUAD AND YEAR IN DESCRIPTION)	BM NUMBER
BASELINE (1975)	694.722	L&BN 4FT N/O BCR @ S END C B 60FT N & 30FT W C/L INT DEL MAR BLVD & SAN GABRIEL BLVD	CG 3604
BASELINE (1975)	693.950	L&BN W CB 1FT N/O BCR 55FT S & 30FT W C/L INT DEL MAR BLVD & SAN GABRIEL BLVD	CG 3605
BASELINE (1975)	635.501	L & BN IN N CB OF SERVICE RD 68FT N & 105FT E C/L INT FOOTHILL BLVD & BALDWIN AVE	CG 4015
PASADENA (1980)	690.307	PK & TAG IN CB 4FT E BCR 18FT N & 57FT E C/L INT BALDWIN AVE & HAMPTON RD MKD (BM)	CG 4016
PASADENA (1980)	691.817	RDBM TAG @ S END C B IN E CB SERVICE RD 30FT N & 45FT W C/L INT BALDWIN AVE & HAMPTON RD	CG 4017
PASADENA (1980)	739.932	RDBM TAG IN CB 23FT E BCR 18FT S & 63FT E C/L INT BALDWIN AVE & CRANGE GROVE AVE	CG 4018
PASADENA (1980)	743.182	RDBM TAG IN S END C B 35FT N & 30FT W C/L INT BALDWIN AVE & ORANGE GROVE AVE	CG 4019
PASADENA (1980)	767.822	RDBM TAG IN CB 26FT E C/L BALDWIN AVE & 8.5FT S C/L PRCD BONITA AVE	CG 4020
PASADENA (1980)	770.429	RDBM TAG IN CB 2FT W BCR 18FT N & 43FT W C/L INT BALDWIN AVE & BONITA AVE	CG 4021
PASADENA (1980)	828.720	RDBM TAG IN WK 2FT E/O E CB & 30FT N/O BCR @ NE COR SIERRA MADRE BLVD & BALDWIN AVE 68FT N & 30FT E C/L INT	CG 4023
PASADENA (1980)	774.865	RDBM TAG IN CB 1FT N C B 92FT N & 20FT W C/L INT SIERRA MADRE BLVD & MT TRAIL AVE	CG 4024
PASADENA (1980)	765.353	RDBM TAG IN CB 90FT S & 20FT E C/L INT SIERRA MADRE BLVD & MT TRAIL AVE	CG 4025
PASADENA (1980)	742.424	RDBM TAG IN CB 2FT N C B 62FT N & 20FT E C/L INT SIERRA MADRE BLVD & CANON AVE	CG 4027
PASADENA (1980)	666.947	RDBM TAG 8FT N BCR 55FT N & 20FT W C/L INT SIERRA MADRE BLVD & CLARIDGE ST	CG 4028
PASADENA (1980)	666.276	RDBM TAG IN CB 2FT S BCR 44FT N & 20FT E C/L INT SIERRA MADRE BLVD & CLARIDGE ST	CG 4029
BASELINE (1975)	652.354	LACS MON IN WELL 10IN DN @ APPROX C/L INT SANTA ANITA AVE (E BARREL) & SIERRA MADRE BLVD MKD I-5	CG 4031
BASELINE (1975)	587.370	LACS MON IN WELL 11IN DN 10FT E & 3FT S C/L INT SANTA ANITA AVE (E BARREL) & ORANGE GROVE AVE MKD (I-6A)	CG 4032

QUAD-YEAR	ELEV	DESCRIPTION (INCLUDE QUAD AND YEAR IN DESCRIPTION)	BM NUMBER
BASELINE (1975)	661.669	RDBM TAG IN E CB 6FT N/O BCR S END OF C B @ NE COR CALIFORNIA BLVD & SAN GABRIEL BLVD 52FT N & 27FT E C/L INT	CG 4122
BASELINE (1975)	694.299	LACS BM DISC E CB 19FT N/O BCR N END C B @ NE COR DEL MAR BLVD & SAN GABRIEL BLVD 75FT N & 30FT E C/L INT MKD (BM 10-7A 1971 RE5869)	CG 4123
BASELINE (1975)	718.344	LACS BM DISC 1FT W/O W CB @ SW COR COLORADO BLVD & SAN GABRIEL BLVD 107FT S & 32FT W C/L INT MKD (BM 10-7B 1971 RE5869)	CG 4124
BASELINE (1975)	741.908	LACS BM DISC 1FT W/O W CB N WALL C B 14FT N/O BCR @ NW COR FOOTHILL BLVD & DAISY AVE 65FT N & 19FT W C/L INT MKD (BM10-8B 1971 RE 5869)	CG 4125
BASELINE (1975)	702.898	RAMSET N CB 1FT W/O BCR @ NW COR HALSTEAD ST & FOOTHILL BLVD 62FT W & 33FT N C/L INT	CG 4126
BASELINE (1975)	701.592	RDBM TAG N CB 1FT E/O BCR @ NE COR HALSTEAD ST & FOOTHILL BLVD 63FT E & 33FT N C/L INT	CG 4127
BASELINE (1975)	691.782	RDBM TAG S CB 7FT E/O BCR @ SW COR ROSEMEAD BLVD & FOOTHILL BLVD 71FT W & 40FT S C/L INT	CG 4128
BASELINE (1975)	693.362	LACS BM DISC 1FT N/O N CB 4FT E/O BCR @ NE COR ROSEMEAD BLVD & FOOTHILL BLVD 68FT E & 49FT N C/L INT MKD (BM 10-9C 1971 RE5869)	CG 4129
BASELINE (1975)	678.983	LACS BM DISC 1FT W/O W CB N WALL C B @ NW COR FOOTHILL BLVD & MICHILLINDA AVE 82FT N & 41FT W C/L INT MKD (BM 10-10A 1971 RE5869)	CG 4130
BASELINE (1975)	675.379	RDBM TAG S CB 1FT E/O BCR @ SE COR FOOTHILL BLVD & MICHILLINDA AVE 83FT E & 39FT S C/L INT	CG 4131
BASELINE (1975)	654.417	LACS BM DISC 4FT BK WK N CB W WALL C B 6FT E/O BCR @ NE COR SERV RD ENT & FOOTHILL BLVD 32FT E & 31FT N C/L INT 241FT W INT DON ALVARADO DR MKD (BM 10-11A 1971 RE5869)	CG 4132
BASELINE (1975)	550.039	LAFC BR DISC W WINGWALL STORM DRAIN CHANNEL 37FT N C/L FOOTHILL BLVD & 381FT E INT RANCHO RD MKD (BM 062 31125 1967)	CG 4133
BASELINE (1975)	543.866	L&SPK CTR CB RET @ SW COR FOOTHILL BLVD & SANTA ANITA AVE 51FT S & 50FT W C/L INT	CG 4134
PASADENA (1980)	871.705	RDBM TAG S CB 1FT W/O BCR @ SW COR LIMA ST & SIERRA MADRA BLVD 32FT W & 28FT S C/L INT	CG 4182

QUAD-YEAR	ELEV	DESCRIPTION (INCLUDE QUAD AND YEAR IN DESCRIPTION)	BM NUMBER
PASADENA (1980)	905.158	CSBM DISK 1FT E/O E CB S END C B 18FT N/O BCR @ NE COR SIERRA MADRE BLVD & MICHILLINDA AVE 90FT N& 26FT E/O C/L INT MKD (BM 25-38 1975 RE 70781)	CG 4183
PASADENA (1980)	904.870	RAMSET N CB 1FT W/O BCR @ NW COR MICHILLINDA AVE & SIERRA MADRE BLVD 56FT W & 75FT N C/L INT	CG 4184
PASADENA (1980)	894.933	RDBM TAG S CB OF S BARREL SIERRA MADRE BLVD @ CENTER OF MAIN ENT TO EUGENE FIELD ELEMENTARY SCHGOL 23FT S & 597FT E INT RIVIERA DR	CG 4185
PASADENA (1980)	884.029	RAMSET N CB 7FT E/O BCR W EDGE C B @ NE COR RIVIERA DR & N BARREL SIERRA MADRE BLVD 67FT E & 22FT N C/L INT	CG 4186
BASELINE (1975)	590.281	L&BR CTR CB RET @ SW COR SANTA ANITA AVE & ORANGE GROVE AVE 52FT W & 25FT S C/L INT	CG 4187
BASELINE (1975)	656.398	LAFC TAG CTR CB RET @ NE COR SANTA ANITA AVE & SIERRA MADRE BLVD 44FT E & 33FT N C/L INT	CG 4188
PASADENA (1980)	759.419	RDBM TAG 1FT E/O BCR @ SE COR FOOTHILL BLVD & ALTADENA DR 46FT E & 32FT S C/L INT	CG 4190
PASADENA (1980)	759.072	RDBM TAG 1FT N/O BCR @ SW COR FOOTHILL BLVD & ALTADENA DR 25FT W & 50FT S C/L INT	CG 4191
PASADENA (1980)	795.071	RDBM TAG 35FT S/O BCR @ SW COR ALTADENA DR & VILLA ST 88FT S & 40FT W C/L INT	CG 4192
PASADENA (1980)	795.806	RDBM TAG 1FT S/O BCR @ SE COR ALTADENA DR & VILLA ST 56FT S & 40FT E C/L INT	CG 4193
PASADENA (1980)	824.018	L&T IN CB RET @ SE COR 29FT E/O C/L BALDWIN AVE & 41FT S/O C/L SIERRA MADRE BLVD	CG 4544
BASELINE (1975)	636.453	RDBM TAG IN SE COR EDISON BOX 2FT W/O CB 7FT N/O BCR 34FT W/O C/L BALDWIN AVE & 65FT N/O C/L FOOTHILL BLVD	CG 4545

QUAD-YEAR	ELEV	DESCRIPTION (INCLUDE QUAD AND YEAR IN DESCRIPTION)	BM NUMBER
LACANADA (1980)	1579.970	HWY BR MON IN CB @ BCR @ NW COR FOOTHILL BLVD & PENNSYLVANIA AVE 40FT N & 85FT W C/L INT	CY 4474
LACANADA (1980)	1574.620	L&BR IN CB 43FT E BCR @ NE COR FOOTHILL BLVD & PENNSYLVANIA AVE 40FT N & 55FT E C/L INT	CY 4475
LACANADA (1980)	1528.050	RAM SET W END HDWL @ NE COR FOOTHILL BLVD & BRIGGS AVE 55FT N & 55FT E C/L INT	CY 4487
LACANADA (1980)	1499.536	L&N IN CB @ BCR @ NW COR FOOTHILL BLVD & OCEAN VIEW BLVD 40FT N & 44FT W/O C/L INT	CY 4488
BASELINE (1975)	1179.840	CS MON IN WELL 5IN DN @ CR NR C/L INT VENTURA ST & LINCOLN AVE MKD (LA CO SUR TRAV STA ALTADENA F 2)	CY 4528
BASELINE (1975)	1180.511	ROUND HD SPK 4FT E BCR @ NE COR LINCOLN AVE & VENTURA ST 15FT N & 34FT E C/L INT MKD (AE 239)	CY 4529
BASELINE (1975)	1221.233	CS BR CAP IN WELL 10IN DN @ CR NR C/L INT LINCOLN AVE & MENDOCINO ST MKD (LA CO SUR CONT SYS TRAV STA ALTADENA F1)	CY 4530
BASELINE (1975)	1256.633	ROUND HD SPK 2FT E BCR @ SE COR LINCOLN AVE & ALTADENA DR 27FT S & 96FT E C/L INT	CY 4533
BASELINE (1975)	1133.451	CS MON IN WELL 8IN DN NR C/L INT LINCOLN AVE & FIGUEROA DR MKD (LA CC SUR TRAV STA ALTADENA E2)	CY 4683
BASELINE (1975)	1135.551	ROUND HD SPK E CB 2FT N BCR 27FT E C/L LINCOLN AVE 40FT N C/L FIGUEROA DR MKD (AE 242)	CY 4684
PASADENA (1980)	1084.369	L&T CONC WK @ HSE NO 294 WOODBURY RD 54FT S C/L & 600FT W C/L GLENROSE AVE MKD (BM)	CY 4686
LACANADA (1980)	1342.142	L&T CONC WK TO HSE NO 2556 MONTROSE AVE 45FT S C/L & 73FT E C/L ROSEMONT AVE MKD (BM)	CY 4729
LACANADA (1980)	1323.452	CRESCENTA WATER CO BR MON @ NW COR MONTROSE AVE & BRIGGS AVE 75FT N & 20FT W/O C/L INT 17FT SLY BCR (USE POINT OF ARROW)	CY 4730
LACANADA (1980)	1317.958	ROBM TAG S CB 30FT E BCR 40FT S C/L MONTROSE AVE & 125FT E/O C/L FLORENCITA DR INT	CY 4731
PASADENA (1980)	920.277	(X) IN S BOLT OF TOP TO FIRE PLUG W SIDE SIERRA MADRE VILLA AVE 15FT N OF PP NO 792487E 50FT S CALVERT RD	CY 4793
PASADENA (1980)	963.151	L&T W CB 1FT N BCR 35FT N & 27FT W C/L INT SIERRA MADRE VILLA AVE & MESITA RD MKD (BM)	CY 4794

QUAD-YEAR	ELEV	DESCRIPTION (INCLUDE QUAD AND YEAR IN DESCRIPTION)	BM NUMBER
PASADENA (1980)	962.802	BM MON IN WELL 10IN DN CN CR NR C/L SIERRA MADRE VILLA AVE 46FT N C/L INT MESITA RD	CY 4795
PASADENA (1980)	1093.704	RDBM TAG IN S CB 1FT W BCR 15FT S & 38FT W C/L INT SIERRA MADRE VILLA AVE & E VILLA KNCLLS DR	CY 4796
PASADENA (1980)	1097.356	RDBM TAG IN W CB 1FT N BCR 18FT W & 45FT N C/L INT SIERRA MADRE VILLA AVE & E VILLA KNOLLS DR	CY 4797
PASADENA (1980)	1200.395	L&T CONC ROCK WALL CN OR NR C/L PROD BARHITE ST (TO THE EAST) 22FT W SIERRA MADRE VILLA AVE	CY 4798
PASADENA (1980)	1205.549	L&T CONC ROCK WALL 43FT W 1/4 13FT S C/L INT SIERRA MADRE VILLA AVE & BARHITE ST (TO THE W)	CY 4799
PASADENA (1980)	1285.089	RDBM TAG CONC CB 1FT S BCR 43FT S & 18FT W C/L INT SIERRA MADRE VILLA AVE & E VILLA MESA RD	CY 4800
PASADENA (1980)	1294.382	RDBM TAG CONC CB 1FT N BCR 43FT N & 18FT W C/L INT SIERRA MADRE VILLA AVE & E VILLA MESA RD	CY 4801
PASADENA (1980)	1329.222	RDBM TAG OLD CONC POST BASE 2FT E BRICK GATE PGST (ENT KINNELCA RANCH) 7FT N APPROX C/L SIERRA MADRE VILLA AVE 19FT E/O NORTH VILLA HEIGHTS RD	CY 4803
PASADENA (1980)	950.822	RDBM TAG 1ST CONC STEP TO ENT FIRE DEPT YARD 44FT S & 295FT W/O C/L INT EATON CYN DR & KINNELCA CYN RD	CY 4809
LACANADA (1980)	2130.463	RDBM TAG IN N CB 1FT W/O BC OF MARKRIDGE RD 15FT N/O C/L MARKRIDGE RD & 165FT E/O C/L PINE COVE RD	CY 4901
LACANADA (1980)	2066.820	L&T S CB 1FT W BCR @ SW COR MARKRIDGE RD & RAMSDELL AVE 15FT S & 42FT W C/L INT	CY 4904
LACANADA (1980)	2025.692	L&BN NR CTR E EDGE CONC COLLAR GRATING DROP INLET NR SE COR MARKRIDGE RD & PENNSYLVANIA AVE 48FT S & 16FT E/O C/L INT MKD (BM)	CY 4905
LACANADA (1980)	2027.517	RDBM TAG W CB 3FT S FUTURE BCR @ SW COR MARKRIDGE RD & PENNSYLVANIA AVE 38FT S & 18FT W C/L INT	CY 4906
LACANADA (1980)	1932.898	L&BN E CB 2FT S BCR @ NE COR PENNSYLVANIA AVE & FRANCIS AVE 36FT N & 24FT E/O C/L INT (BM 40 175)	CY 4907

QUAD-YEAR	ELEV	DESCRIPTION (INCLUDE QUAD AND YEAR IN DESCRIPTION)	BM NUMBER
LACANADA (1980)	1928.717	RDBM TAG S CB 1FT E BCR @ SE COR PENNSYLVANIA AVE & FRANCIS AVE 15FT S & 49FT E C/L INT	CY 4908
LACANADA (1980)	1833.715	RDBM TAG N CB 1FT W BCR @ NW COR PENNSYLVANIA AVE & ORANGE AVE 28FT N & 50FT W OUT	CY 4909
LACANADA (1980)	1829.437	RDBM TAG S CB 2FT W BCR @ SW COR PENNSYLVANIA AVE & ORANGE AVE 28FT S & 40FT W C/L INT	CY 4910
PASADENA (1980)	1006.760	US&GS DISC IN CON CB 100FT N & 32FT E C/L INT VERANADA AVE & ALTADENA DR MKD (Z 172 RESET 1968)	CY 4942
PASADENA (1980)	1003.832	ROUND HD SPK E CB @ BCR @ SE COR 81FT S & 20FT E C/L INT NEW YORK DR & HARDING AVE MKD (AE 11)	CY 4947
PASADENA (1980)	1040.360	RDBM TAG E CB 24FT N BCR @ NE COR NEW YORK DR & PEPPER DR 50FT N & 18FT E/O C/L INT 5FT N/C C B	CY 4949
PASADENA (1980)	1041.072	CS MON IN WELL 10IN DN @ PI CURVE ON NEW YORK DR 70FT W C/L PEPPER DR S MKD (RE 63) USE S EDGE	CY 4950
PASADENA (1980)	1070.915	RDBM TAG 120FT N & 20FT E C/L INT NEW YORK DR & MIDLOTHIAN DR	CY 5058
PASADENA (1980)	1072.612	RDBM TAG 160FT N & 20FT W C/L INT NEW YORK DR & MIDLOTHIAN DR 15FT N BCR	CY 5059
PASADENA (1980)	1131.755	RDBM TAG 110FT N & 20FT W C/L INT NEW YORK DR & ALLEN AVE 50FT N/C BCR	CY 5060
PASADENA (1980)	1128.996	CS BR CAP IN CONC FLUSH 2FT N CB 22FT N & 84FT W C/L INT NEW YORK DR & ALLEN AVE MKD (CO CONTROL SYS ALTADENA K 3 RM NO 1 1960 RE 5869)	CY 5061
PASADENA (1980)	1146.081	RDBM TAG 66FT S & 15FT E C/L INT NEW YORK DR & SIERRA BONITA AVE	CY 5062
PASADENA (1980)	1147.681	L&SPK S CB 3FT W BCR 18FT S & 36FT W C/L INT SIERRA BONITA AVE & NEW YORK DR MKD (C 29 BM)	CY 5063
PASADENA (1980)	1153.297	SPK S CB 3FT W/O BCR 18FT S 29FT W C/L INT HOLLISTON AVE & NEW YORK DR MKD (BM-B10)	CY 5065
PASADENA (1980)	1152.239	RDBM TAG TOP CONC RETAINING WALL 1FT HIGH 30FT E & 40FT S C/L INT MAR VISTA AVE & NEW YORK DR	CY 5066
PASADENA (1980)	1108.635	L&SPK N CB 20FT N & 62FT E C/L INT EL MOLINO AVE & NEW YORK DR	CY 5070

QUAD-YEAR	ELEV	DESCRIPTION (INCLUDE QUAD AND YEAR IN DESCRIPTION)	BM NUMBER
PASADENA (1980)	1101.984	L&T N EDGE DRWY 48FT E & 142FT N C/L INT EL MCLINC AVE & WOODBURY RD	CY 5071
PASADENA (1980)	1097.017	L&T N SIDE OF DRWY 30FT E & 125FT N C/L INT MADISON AVE & WOODBURY RD	CY 5072
BASELINE (1975)	1304.130	CS MON IN WELL 1FT E C/L LINCOLN AVE & 8FT S C/L LOMA ALTA DR MKD (TRA STA MOUNT LOWE E 12 RE 2177 1940)	CY 5077
BASELINE (1975)	1303.160	L&T NR N END CONC WK TO HSE NO 748 31FT S C/L LOMA ALTA DR 65FT E C/L LINCOLN AVE	CY 5078
PASADENA (1980)	1357.134	L&T NR S END WK HSE NO 513 31FT N C/L LOMA ALTA DR & 40FT E C/L THURIN AVE	CY 5080
PASADENA (1980)	1410.244	CS MON IN WELL @ C/L INT LOMA ALTA DR & OLIVE AVE MKD (CS RE 5869)	CY 5081
PASADENA (1980)	1412.528	L&T IN S CB @ BCR SE COR OLIVE AVE & LOMA ALTA DR 19FT S & 24FT E C/L INT	CY 5082
PASADENA (1980)	1483.003	BT SPK N CB 1FT W BCR @ NW COR GLENROSE AVE & LOMA ALTA DR 23FT W & 20FT N C/L INT MKD (AE 421)	CY 5083
PASADENA (1980)	1484.750	RDBM TAG S CB 3FT E BCR @ SE COR GLENROSE AVE & LOMA ALTA DR 20FT S & 20FT E C/L INT	CY 5084
PASADENA (1980)	1551.300	SPK N CB 8FT W BCR @ NW COR LOMA ALTA DR & FAIROAKS AVE 20FT N & 30FT W C/L INT	CY 5085
PASADENA (1980)	1549.696	L&T S CB 4FT E/O BCR @ SE COR WAPELLO ST & FAIROAKS AVE 52FT E & 15FT S C/L INT	CY 5086
PASADENA (1980)	1580.251	FC MON @ SE COR FC PROPERTY 20FT N C/L LOMA ALTA DR & 590FT E/O MC NALLY AVE MKD (RWA BM 15-123 1937)	CY 5087
PASADENA (1980)	1647.408	LACE TAG S CB 1FT W/O BCR @ SW COR ALTA PINE DR & LOMA ALTA DR 20FT S & 42FT W/O C/L INT	CY 5089
PASADENA (1980)	1653.196	LACE TAG S CB 1FT E/O BCR @ SE COR ALTA PINE DR & LOMA ALTA DR 20FT S & 42FT E/O C/L INT	CY 5090
PASADENA (1980)	1688.019	L&BN N CB 1FT W/O END CB @ NE COR CANON BLVD & LOMA ALTA DR 15FT N & 49FT E/O C/L INT	CY 5091
PASADENA (1980)	1753.991	CS MON IN WELL @ C/L INT LOMA ALTA DR & MORENGO AVE MKD (RE 2177)	CY 5092

QUAD-YEAR	ELEV	DESCRIPTION (INCLUDE QUAD AND YEAR IN DESCRIPTION)	BM NUMBER
PASADENA (1980)	1758.449	LACE TAG N CB 20FT N C/L LOMA ALTA DR & 24FT E C/L PROD MORENGO AVE 2FT E DRWY HSE NO 493	CY 5093
PASADENA (1980)	1800.481	LACS MON IN WELL @ C/L INT LOMA ALTA DR & LAKE AVE (MKD R E 2177)	CY 5094
PASADENA (1980)	1805.410	L&T N END CONC SLAB OF CONC & STONE BENCH 56FT E C/L PROD LAKE AVE & 9FT N C/L PROD LOMA ALTA DR	CY 5095
PASADENA (1980)	1717.350	BT SPK S CB 2FT E BCR @ SE COR LAKE AVE & MOUNT CURVE AVE 15FT S & 60FT E C/L INT MKD (AE 725)	CY 5097
PASADENA (1980)	1609.004	BT SPK E CB 2FT S BCR @ NE COR WAPELLO ST & LAKE AVE 25FT E & 70FT N C/L INT MKD (AE 597A)	CY 5098
PASADENA (1980)	1599.270	RDBM TAG E CB 2FT N BCR @ SE COR WAPELLO ST & LAKE AVE 25FT E & 36FT S C/L INT	CY 5099
PASADENA (1980)	1488.127	CS MON IN WELL @ C/L INT LAKE AVE & DOLORES DR TO THE E MKD (RE 2177)	CY 5100
PASADENA (1980)	1485.828	BT SPK E CB 5FT S BCR @ SE COR DOLORES DR & LAKE AVE 28FT E & 33FT S C/L INT MKD (AE 31)	CY 5101
PASADENA (1980)	1378.671	CS MON C/L INT ALTADENA DR & HOLLISTON AVE MKD (RE 2177)	CY 5113
PASADENA (1980)	1377.355	L&SPK CONC HDWL @ SE COR ALTADENA DR & HOLLISTON AVE 30FT S & 21FT E C/L INT	CY 5114
PASADENA (1980)	1152.027	USC&GS MON TOP CONE SHAPE ROCK 55FT N C/L ALTADENA DR & 32FT E OF E CB PROD ROOSEVELT AVE MKD (A 173 1934)	CY 5115
LACANADA (1980)	1917.835	RDBM TAG E CB BRIGGS AVE 1FT S BCR @ SE COR HENRIETTA AVE 21FT E & 42FT S C/L INT	CY 5653
LACANADA (1980)	1922.944	RDBM TAG E CB BRIGGS AVE 1FT N BCR @ NE COR HENRIETTA AVE 21FT E & 42FT N C/L INT	CY 5654
LACANADA (1980)	2027.136	RDBM TAG E CB BRIGGS AVE 1FT N BCR @ NE COR PICKENS CN RD & BRIGGS AVE 21FT E & 53FT N C/L INT	CY 5655
LACANADA (1980)	2035.400	RDBM TAG W CB BRIGGS AVE 12FT S END OF CB 21FT W C/L BRIGGS AVE & 150FT N C/L PROD PICKENS CN RD	CY 5656
LACANADA (1980)	2083.397	RDBM TAG CONC SLAB 3FT W PP NO 563573E 19FT E C/L BRIGGS AVE & 36FT S C/L PROD OLIVE AVE	CY 5657

QUAD-YEAR	ELEV	DESCRIPTION (INCLUDE QUAD AND YEAR IN DESCRIPTION)	BM NUMBER
PASADENA (1980)	1356.727	RD HD SPK & L N CB CF BRIDGE ABUT 12FT W BCR @ NW COR ALTADENA DR & CREST DR 53FT W & 20FT N APPROX C/L INT MKD (BM AE 779)	CY 6485
PASADENA (1980)	1383.705	CS MON IN WELL 10IN DN @ C/L INT ALTADENA DR & PORTER AVE MKD (RE 2177)	CY 6488
PASADENA (1980)	1383.729	RD HD SPK S CB 1FT W BCR @ SW COR ALTADENA DR & TANGBLE DR 16FT S & 27FT W C/L INT MKD (BM NG 6)	CY 6489
PASADENA (1980)	1385.487	RDBM TAG W CB 1FT N BCR @ NW COR ALTADENA DR & TANGBLE DR 40FT N & 15FT W C/L INT	CY 6490
PASADENA (1980)	1332.142	CS MON IN WELL 14IN DN 27FT N & 64FT W/O WLY INT ALTADENA DR & CRESCENT DR MKD (BM 24-30 1952)	CY 6491
PASADENA (1980)	1334.403	USC&GS MON FLUSH IN S WALL C B 84FT N & 20FT E/O WLY INT ALTADENA DR & CRESCENT DR (USE NE SIDE) MKD (F 1148 1961)	CY 6492
PASADENA (1980)	1292.544	RD HD SPK S CB 6FT W BCR @ SW COR ALTADENA DR & MENDOCINO LANE 16FT S & 100FT W APPROX C/L INT MKD (BCM 67)	CY 6493
PASADENA (1980)	1286.169	CSBM FLUSH IN C B 50FT N & 57FT E/O ELY INT ALTADENA DR & CRESCENT DR MKD (BM 24-31A 1963)	CY 6494
PASADENA (1980)	1143.530	SQ HD SPK & 1 WEST CB 9FT E BCR @ SE COR ALTADENA DR & ROCSEVELT AVE 70FT E & 22FT S C/L INT MKD (AE 687)	CY 6497
PASADENA (1980)	1073.789	SPK N CB BCR @ NW COR 18FT W/O GLENN CYN RD & 15FT N/O HARDING AVE MKD (AE 204)	CY 6498
PASADENA (1980)	1071.302	CS MON IN WELL 8IN DN @ C/L INT HARDING AVE & GLENN CYN RD MKD (RE 63) 1FT E/O EDGE X-GUT	CY 6499
PASADENA (1980)	1029.057	RDBM TAG E CB ALTADENA DR 30FT E C/L & 20FT N C/L PROD BERENDO ST	CY 6500
PASADENA (1980)	1369.001	L&T E CB 24FT E C/L PINECREST DR & 45FT N C/L ALTADENA DR MKD (BM)	CY 6503
BASELINE (1975)	1220.289	SPK 4FT E BCR @ SE COR LINCOLN AVE & MENDOCINO ST 62FT E 22FT S C/L INT MKD (AE 237)	CY 6505
BASELINE (1975)	1254.285	CS MON @ C/L INT LINCOLN AVE & ALTADENA DR MKD (RE 63)	CY 6506
BASELINE (1975)	1285.143	L&T IN CTR CONC DR TO HSE NO 3180 LINCOLN AVE 38FT E & 130FT S C/L PALM ST	CY 6507

QUAD-YEAR	ELEV	DESCRIPTION (INCLUDE QUAD AND YEAR IN DESCRIPTION)	BM NUMBER
PASADENA (1980)	1463.475	SPK S CB LOMA ALTA DR 4FT E C/L PROD CHANEY TRAIL MKD (AE 420)	CY 6509
PASADENA (1980)	1753.665	L&T 22FT E BCR @ SE COR LAKE AVE & ALTA PINE DR 90FT E & 18FT S C/L INT STAMPED (RE 2000)	CY 6510
PASADENA (1980)	1746.328	SPK 1FT N/O BCR @ SE COR LAKE AVE & ALTA PINE DR 55FT S & 25FT E C/L INT	CY 6511
PASADENA (1980)	977.681	L&T IN CB RET @ SE COR NEW YORK DR & ALTADENA DR 14FT W BCR 22FT S & 53FT E C/L INT	CY 6527
PASADENA (1980)	1152.768	L&BN IN CB E SIDE KINNELGA CYN RD 525FT N & 15FT E/O C/L KINCLAIR DR @ S END C B	CY 6533
PASADENA (1980)	1268.497	L&T @ BCR SW COR KINNELGA CYN RD & BRAMBLING LANE 35FT W & 15FT S C/L INT	CY 6534
PASADENA (1980)	1274.719	FC BR MON FLUSH IN CB @ NW COR KINNELGA CYN RD & BRAMBLING LANE 55FT N & 13FT W C/L INT MKD (BM 60-108)	CY 6535
PASADENA (1980)	1159.438	BM MON IN WELL ON C/L SIERRA MADRE VILLA & 35FT S FAIRPOINT ST MKD (BM)	CY 6536
PASADENA (1980)	1047.305	ZIN IP W/CONC PLUG & BRASS SPK 10IN DN IN WELL ON C/L SIERRA MADRE VILLA & 45FT N/O TREVAN RD (LID MKD BM)	CY 6537
PASADENA (1980)	853.100	LACS BR CAP MON FL IN N CB OF S BARREL 90FT E & 25FT N C/L INT SIERRA MADRE VILLA AVE & SIERRA MADRE BLVD S BBL MKD (24-44A 1963 RE 5869)	CY 6539
PASADENA (1980)	851.060	L&BR IN CB RET 2FT W/O BCR @ SE COR SIERRA MADRE VILLA AVE & SIERRA MADRE BLVD S BARREL 85FT E & 24FT S C/L INT	CY 6540
PASADENA (1980)	780.625	L&T @ BCR @ NW COR SIERRA MADRE VILLA & ORANGE GROVE BLVD 70FT N & 40FT W C/L INT	CY 6541
PASADENA (1980)	778.093	RAMSET IN WLY 1/3 CB RET 46FT W & 33FT S/O C/L INT SIERRA MADRE VILLA AVE & ORANGE GROVE BLVD	CY 6542
PASADENA (1980)	738.097	L&LS TAG NO 2959 W CB SIERRA MADRE VILLA AVE ON C/L PROD ELECTRONIC DR	CY 6543
PASADENA (1980)	836.967	CS BR CAP MON FLUSH IN CB @ NE COR ALTADENA DR & PALCMA DR 55FT N & 35FT E C/L INT MKD (SIERRA MADRE A-5A RM 4 1963 RE 5869)	CY 6550

QUAD-YEAR	ELEV	DESCRIPTION (INCLUDE QUAD AND YEAR IN DESCRIPTION)	BM NUMBER
PASADENA (1980)	834.824	L&BRAD IN CTR CB RET @ SW COR ALTADENA DR & PALCMA DR 40FT W & 38FT S MKC (BM)	CY 6551
LACANADA (1980)	1392.594	RDBM TAG IN HDWL OF CONC CHANNEL 191FT E & 45FT N C/L INT MONTROSE AVE & PENNSYLVANIA AVE	CY 6561
LACANADA (1980)	1641.435	RDBM TAG S CB 1FT W BCR @ SW COR BRIGGS AVE & FAIRMOUNT AVE 20FT S & 45FT W C/L INT	CY 6577
LACANADA (1980)	1644.819	BT SPK N CB @ BCR @ NW COR BRIGGS AVE & FAIRMOUNT AVE 20FT N & 45FT W C/L INT	CY 6578
LACANADA (1980)	1761.638	L&BN CONC FTG OF BLOCK WL @ NW COR BRIGGS AVE & LOS AMIGOS ST 25FT N & 20FT W C/L INT MKD (BM)	CY 6579
LACANADA (1980)	1956.217	RDBM TAG N CB 1FT W END OF CB 35FT W & 17FT N C/L INT ROCKDELL ST & ROSEMONT AVE	CY 6581
LACANADA (1980)	1955.669	RDBM TAG S CB 1FT W BCR @ SW COR ROCKDELL ST & ROSEMONT AVE 17FT S & 45FT W C/L INT	CY 6582
LACANADA (1980)	2129.701	RDBM TAG SE COR BRIDGE B 1301 3FT W/O E END 128 FT E & 13FT S C/L INT MARKRIDGE RD & PINE CONE RD	CY 6585
LACANADA (1980)	1752.996	RD HD SPK&L N CB 2FT E BCR @ NE COR PENNSYLVANIA AVE & EL CAMINITO ST 15FT N & 34FT E/O C/L INT	CY 6587
LACANADA (1980)	1749.165	RDBM TAG S CB 1FT E/O BCR @ SE COR PENNSYLVANIA AVE & EL CAMINITO ST 18FT S & 77FT E/O C/L INT	CY 6588
LACANADA (1980)	1677.777	BT SPK N CB 2FT W/O BCR @ NW COR 98FT WLY C/L PENNSYLVANIA AVE & 18FT SLY C/L LOS OLIVOS LANE	CY 6589
LACANADA (1980)	1671.976	RDBM TAG S CB 3FT E FUTURE BCR @ SE COR PENNSYLVANIA AVE & LOS OLIVOS LANE 20FT S & 97FT E C/L INT	CY 6590
LACANADA (1980)	1467.417	L&SPK IN SLY CB 5FT WLY BCR @ SWLY COR 58FT WLY C/L PENNSYLVANIA AVE & 20FT SLY C/L ALTURA AVE MKD (BM)	CY 6592
BASELINE (1975)	1312.934	L&CS TAG IN E CB LINCOLN AVE 29FT S & 20FT E/O C/L INT OF CANYON CREST RD	CY 7683
BASELINE (1975)	1314.492	L&CS TAG IN E CB LINCOLN AVE 20FT E/O C/L LINCOLN AVE ON CANYON CREST RD C/L PRCD	CY 7684
BASELINE (1975)	1365.611	RD MON 8IN DN IN WELL ON PI LINCOLN AVE & 900FT N/O C/L LOMA ALTA AVE	CY 7685

QUAD-YEAR	ELEV	DESCRIPTION (INCLUDE QUAD AND YEAR IN DESCRIPTION)	BM NUMBER
BASELINE (1975)	1085.502	RDBM IN WELL @ P.I. OF WOODBURY RD 200FT W C/L LINCOLN AVE MKD (LACCRD 1956)	CY 7708
BASELINE (1975)	1087.905	RDBM TAG W CB 2FT N BCR @ NW COR LINCOLN AVE & WOODBURY RD 100FT N & 30FT W C/L INT	CY 7709
LACANADA (1980)	1844.708	RDBM TAG E CB 1FT N BCR @ NE COR BRIGGS AVE & ORANGE COVE AVE 48FT N & 20FT E C/L INT	CY 7715
LACANADA (1980)	1826.040	RDBM TAG E CB 1FT S BCR @ SE COR BRIGGS AVE & ORANGE COVE AVE 48FT S & 20FT E C/L INT	CY 7716
PASADENA (1980)	1119.271	RDBM TAG E CB 2FT N BCR @ NE COR WOODBURY RD & FAIROAKS AVE 75FT N & 43FT E C/L INT	CY 7719
PASADENA (1980)	1118.805	RDBM TAG W CB 1.5FT N BCR @ NW COR WOODBURY RD & FAIROAKS AVE 75FT N & 43FT W C/L INT	CY 7720
PASADENA (1980)	1090.685	SPK IN W CB GLENROSE AVE 15FT W C/L & 133FT N C/L WOODBURY RD MKD (AE 536)	CY 7721
PASADENA (1980)	1028.573	LAFC TAG S CB 3FT W BCR @ SW COR ALTADENA DR & BERENDO ST 60FT W & 30FT S C/L INT	CY 7725
PASADENA (1980)	982.198	RDBM TAG 2FT N BCR @ NW COR ALTADENA DR & NEW YORK DR 85FT N & 30FT W/O C/L INT	CY 7726
PASADENA (1980)	870.877	RDBM TAG 1FT N/O BCR @ NW COR ALTADENA DR & CASA GRANDE ST 46FT N & 30FT W C/L INT	CY 9462
PASADENA (1980)	909.501	LACRD MON IN WELL C/L INT ALTADENA DR & WASHINGTON BLVD MKD (LACRD 1971)	CY 9464
PASADENA (1980)	1133.412	RDBM TAG E CB 1FT N/O BCR @ SE COR NEW YORK DR & LAKE AVE 48FT S & 34FT E C/L INT	CY 9467
PASADENA (1980)	1137.756	RDBM TAG E CB 1FT S/O BCR @ NE COR NEW YORK DR & LAKE AVE 60FT N & 34FT E C/L INT	CY 9468
PASADENA (1980)	1101.110	LACRD BR CAP MON IN WELL C/L INT SANTA ROSA AVE TO NORTH & WOODBURY RD MKD (LACRD 1970)	CY 9469
PASADENA (1980)	1103.905	CSBM DISK 1FT N/O N CB @ BCR NW COR SANTA ROSA AVE TO NORTH & WOODBURY RD 48FT W & 43FT N C/L INT MKD (BM 24-15A 1971 RE 5869)	CY 9470
PASADENA (1980)	1121.033	RDBM TAG N CB 4FT E/O BCR @ NW COR SANTA ANITA AVE & WOODBURY RD 72FT W & 41FT N C/L INT	CY 9471

QUAD-YEAR	ELEV	DESCRIPTION (INCLUDE QUAD AND YEAR IN DESCRIPTION)	BM NUMBER
PASADENA (1980)	1365.762	RDBM TAG N CB OF NORTH VILLA HEIGHTS RD 15FT E OF E GATE POST 512FT W & 10FT N OF N VILLA HEIGHTS RD (WEST) & N VILLA HEIGHTS RD (OPP E EDGE OF DR TO HSE 2097)	CY 9472
PASADENA (1980)	1364.222	RDBM TAG 1FT E/O SW EDGE CONC SLAB @ BASE OF WALL 4FT N & 7FT W/O COR WALL 6FT N/O APPROX C/L OF N VILLA HEIGHTS RD (WEST) & 540FT W/O N VILLA HEIGHTS RD (OPP WEST EDGE DR TO HSE # 2097)	CY 9473
PASADENA (1980)	958.765	RDBM TAG 1FT E/O BCR @ NE COR KINNELOA CYN RD & EATON CYN DR 45FT E & 16FT N/O C/L INT	CY 9474
PASADENA (1980)	1370.376	L&PK NAIL 2FT N/O BCR @ NW COR PINECREST DR & ALTADENA DR 76FT N & 15FT W C/L INT	CY 9475
PASADENA (1980)	1385.834	RDBM TAG IN CB 1FT N/O BCR @ NE COR ALTADENA DR & PORTER AVE 30FT N & 14FT E C/L INT	CY 9476
PASADENA (1980)	1372.485	L&T NR CTR CB RET @ NE COR ALTADENA DR & LAKE AVE 53FT N & 53FT E C/L INT	CY 9477
PASADENA (1980)	1371.248	CSBM MON 15FT N/O BCR @ NW COR ALTADENA DR & LAKE AVE 88FT N & 32FT W/O C/L INT MKD (BM 24- 25A)	CY 9478
PASADENA (1980)	941.325	L&T 1FT N/O BCR @ NW COR ALTADENA DR & GARFIAS DR 30FT W & 41FT N C/L INT	CY 9479
PASADENA (1980)	1006.726	L&T 3FT W/O BCR @ SW COR NEW YORK DR & HARDING AVE 25FT S & 42FT W HARDING AVE TO SOUTH	CY 9480
PASADENA (1980)	807.571	L&T IN CB 14FT W/O BCR @ SW COR SIERRA MADRE BLVD N BBL & WASHINGTON BLVD 24FT S & 50FT W C/L INT	CY 9481
PASADENA (1980)	807.985	MWD BR DISC IN CB 80FT W/O BCR @ NW COR SIERRA MADRE BLVD N BBL 150FT W/O C/L WASHINGTON BLVD & 24FT N/O C/L INT MKD (MWD 8-29)	CY 9482
PASADENA (1980)	1120.464	CSBM MON IN N WALL C B 45FT N/O BCR @ NW COR FAIROAKS AVE WOODBURY RD 120FT N & 44FT W C/L INT MKD (BM 24-16A 1971)	CY 9484
PASADENA (1980)	1292.821	L&T NR CTR CB RET @ NE COR LAKE AVE & MARCHETA ST 30FT N & 35FT E C/L INT	CY 9485
PASADENA (1980)	1292.971	L&T 2FT N/O BCR @ SW COR LAKE AVE & MARIPOSA ST 34FT W & 60FT S C/L INT	CY 9486

QUAD-YEAR	ELEV	DESCRIPTION (INCLUDE QUAD AND YEAR IN DESCRIPTION)	BM NUMBER
PASADENA (1980)	1247.409	CSBM MON IN S WALL C B ON NE COR LAKE AVE & MENDOCINO ST 48FT N 33FT E C/L INT MKD (24-26D 1975)	CY 9487
PASADENA (1980)	1242.947	L&T 8FT S/O BCR @ NW COR LAKE AVE & MENDOCINO ST 37FT W & 33FT N C/L INT	CY 9488
PASADENA (1980)	1185.135	L&T 3FT S/O BCR @ NE COR LAKE AVE & BOSTON ST 44FT N & 33FT E C/L INT	CY 9489
PASADENA (1980)	1183.937	L&T IN W CB 33FT W/O C/L LAKE AVE & 40FT N/O C/L PROD BOSTON ST	CY 9490
LACANADA (1980)	1496.935	RDBM TAG 1FT E/O BCR @ NE COR FOOTHILL BLVD & OCEAN VIEW BLVD 40FT N & 40FT E/O C/L INT	CY 9545
LACANADA (1980)	1526.601	RDBM TAG IN N CB 5FT W/O BCR @ NW COR FOOTHILL BLVD & BRIGGS AVE 40FT N & 48FT W/O C/L INT	CY 9952
LACANADA (1980)	2069.633	RDBM TAG IN SLY CB 5FT ELY BCR @ SE COR MARKRIDGE RD & RAMSDELL AVE 18FT SLY & 73FT ELY C/L INT	CY 9953
LACANADA (1980)	2095.293	RDBM TAG IN S CB 1FT W/O BCR @ SW COR BRIGGS AVE & SHIELDS AVE 15FT SLY & 47FT WLY C/L INT TO WEST	CY 9956
LACANADA (1980)	2099.564	RDBM TAG IN NLY CB 20FT ELY & 15FT NLY C/L INT BRIGGS AVE & SHIELDS AVE TO WEST	CY 9957
LACANADA (1980)	1754.417	L&BN IN E CB BRIGGS AVE 21FT E/O C/L & 53FT SLY C/L LOS AMIGOS ST STMPD (BM)	CY 9958
LACANADA (1980)	2035.522	RDBM TAG IN SLY CB 2FT W/O BCR SWLY COR PINE GLEN RD & MT PINE DR 18FT S & 46FT W/O C/L INT	CY 9959
LACANADA (1980)	2037.957	RDBM TAG IN NLY CB 2FT W/O BCR @ NWLY COR PINE GLEN RD & MT PINE DR 18FT N & 47FT W/O C/L INT	CY 9960
LACANADA (1980)	1472.821	RDBM TAG 1FT N/O BCR @ NWLY COR PENNSYLVANIA AVE & ALTURA AVE 41FT WLY C/L PENNSYLVANIA AVE & 59FT NLY C/L ALTURA AVE	CY 9961
LACANADA (1980)	1390.255	L&SPK IN SLY CB 5FT E/O BCR @ SE COR 131FT E/O C/L PENNSYLVANIA AVE & 37FT S/O C/L MONTROSE AVE	CY 9962
LACANADA (1980)	1383.990	RDBM TAG IN NLY CB 4FT WLY BCR @ NWLY COR 38FT NLY C/L MONTROSE AVE & 63FT WLY C/L RAMSDELL AVE MKD (BM)	CY 9963

QUAD-YEAR	ELEV	DESCRIPTION (INCLUDE QUAD AND YEAR IN DESCRIPTION)	BM NUMBER
LACANADA (1980)	1381.373	S&L IN SLY CB 9FT WLY BCR @ SWLY COR 38FT SLY C/L MONTROSE AVE & 38FT WLY C/L RAMSDALL AVE MKD (BM)	CY 9964
LACANADA (1980)	1351.659	S&L IN SLY CB 13FT WLY BCR @ SW COR 37FT SLY C/L MONTROSE AVE & 51FT WLY C/L LA CRESCENTA AVE MKD (BM)	CY 9965
LACANADA (1980)	1347.494	RDBM TAG IN ELY CB 2FT SLY BCR @ SELY COR 32FT ELY C/L LA CRESCENTA AVE & 57FT SLY C/L MONTROSE AVE	CY 9966
LACANADA (1980)	1343.591	RDBM TAG IN SLY CB 15FT WLY BCR @ SWLY COR 36FT SLY C/L MONTROSE AVE & 44FT WLY C/L ROSEMONT AVE	CY 9967
LACANADA (1980)	1319.332	RDBM TAG IN SLY CB 2FT WLY BCR @ SWLY COR 40FT SLY C/L MONTROSE AVE & 54FT WLY C/L OCEAN VIEW BLVD	CY 9968
LACANADA (1980)	1322.201	RDBM TAG IN ELY CB 2FT NLY BCR @ NELY COR 31FT ELY C/L OCEAN VIEW BLVD & 64FT NLY C/L MONTROSE AVE	CY 9969
LACANADA (1980)	1412.851	RDBM TAG IN E CB 5FT S/O BCR @ SE COR OCEAN VIEW BL & LUANA LN 44FT S & 32FT E/O C/L INT	CY 9970
LACANADA (1980)	1418.361	RDBM TAG IN E CB 4FT N/O BCR @ NE COR OCEAN VIEW BLVD & LUANA LN 41FT N & 32FT E/O C/L INT	CY 9971
PASADENA (1980)	1151.466	RDBM TAG CONC CB @ S END C B 515FT N/O C/L KINCLAIR DR & 15FT W/O C/L KINNELGA CYN RD	CY 10090